

REPAIR PROCESS

DAMAGED METAL PART DOLPHIN™ ONE FILL

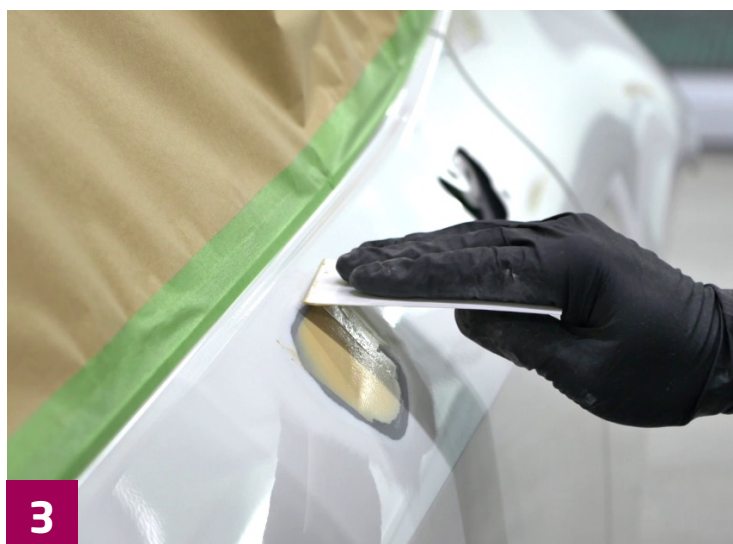

DRIVING SURFACE PERFECTION™



Step 1: Inspect panel

- Clean and inspect panel.
- Use appropriate (Axalta) silicone remover and a suitable degreasing cloth to clean the surface. For more details refer to "Preparatory surface degreasing SOP".

Step 2: Sand the repair

- Sand with DA/orbital sander and P150-P240 abrasive discs to remove imperfections.
- If Body Filler needs to be applied, sand to bare metal with P80 grit to remove existing paintwork.

Step 3: Apply U-POL UP0659 / UP0660 Dolphin™ One Fill

- Blow off panel and clean thoroughly by using an appropriate Axalta silicone remover.
- Mix 2% activator by weight to a 3-4" puddle of body filler. Mix thoroughly together until color is uniform and has no streaks.
- Apply body filler with a spreader in thin coats with firm pressure rather than one heavy coat.
- Air dry - Allow filler to dry for approximately 15 minutes at 70F/21C. Shorter if above, longer if below.
- Infrared dry if available - Dry at 170F/76C for 5 minutes at a distance of 24" - 30".

Step 4: Sand Dolphin™ One Fill

- Sand body filler to shape using a hand block and P120 abrasive strips followed by P180-P240.
- Use **UPOL UP0873 U-POL GUIDE #7** guide coat during all sanding steps.

Step 5: Refine sanding

- Refine block sanded area with DA/orbital sander and P240-P320 discs. Use guide coat during all sanding steps.
- Feather edge/scratch reduction sanding of surrounding area with DA/orbital sander and P240-P320 discs.
- Refine surrounding area with DA/orbital sander and P320-P600 abrasive discs. Ensure graduated sanding steps.
- Blow off panel. Removal of dust from pores and voids is of particular importance prior to the application of primer.
- Use appropriate (Axalta) silicone remover and a suitable degreasing cloth to clean the surface.
- Small voids or micro pores can be filled prior to the application of primer, surfacer or filler by wiping on **U-POL UP0686 MicroFill** using a lint free cloth. Remove excess. Allow to dry for 15 mins (@70F/21C) before applying solvent based primer. Refer to MicroFill TDS Guide for additional information.

Step 6: Apply primer

- Clean thoroughly using appropriate Axalta silicone remover and mask surrounding areas if required.
- Prime bare metal areas immediately using Axalta pretreatment wipes or etch primer and flash-off.
- Mix and apply a suitable Axalta 2K surfacer/filler according to the technical data sheet of the product being used. Use "outside-in" technique to reduce overspray.

Step 7: Sand surfacer/filler

- Apply guide coat and sand repair with a hand block and P320-P400 abrasive strip.
- Re-apply guide coat, sand edges and corners with a suitable foam backed abrasive followed by DA/orbital machine sanding with P500-P600 abrasive discs.

Step 8: Apply topcoat

- Clean thoroughly using an appropriate Axalta silicone remover or water-based cleaner depending on local VOC legislation and clear over base system to be applied.
- Mask panel as required and apply your chosen Axalta clear over base system.



Watch Tutorial

BE SMART:
CLEAN AND TIDY UP



Disclaimer: Check with local regulations to ensure the relevant safety regulations and recommendations meet with local, state, province, region and/or country safety and environmental compliance standards. All information, illustrations and specifications on this process poster are based on the latest product information available at the time of release. Not all products or product systems on this poster may be available in your country and/or region, please contact your local Axalta organization for additional information. Axalta reserves the right to make changes at any time without notice.

axalta.com